

October 2009

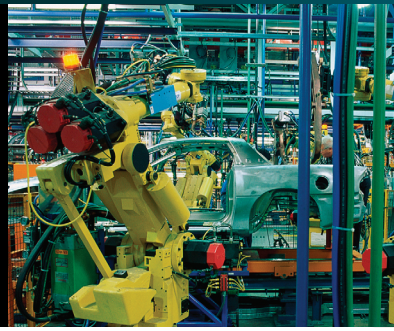
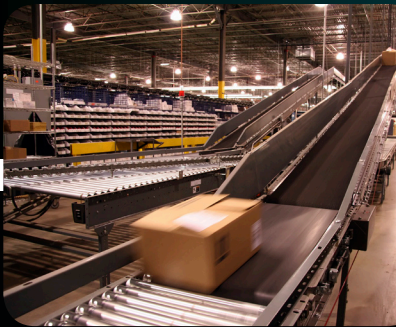

ACCU-Torq[®] Motors Vector Duty Induction Motors

- *Constant Torque Operation from Zero to Base Speed With Vector Drives*
- *Constant HP Operation to Twice Base Speed (except where noted)*
- *Continuous Duty at 40°C Ambient*
- *Optimized for Operation with IGBT and Intelligent-Power-Module Drives (NEMA^{®†} Design-A)*
- *Class F Insulation*
- *Normally Closed Thermostats Standard*
- *Shaft Grounding Ring Option on All Ratings*
- *F-1 Standard, Field Convertible to F-2 for 180 Frame and Above*
- *Encoder and Brake Provision on All Ratings*
- *Three Year Warranty*

Optimize your machine designs with the dynamic performance of ACCU-Torq[®] motors. If you need accurate positioning or precise speed control, but do not require the rapid acceleration dynamics of a servomotor, an encoder equipped ACCU-Torq[®] motor may be the best solution.



EMERSON[™]
Motor Technologies

EMERSON. CONSIDER IT SOLVED[®]

Product Overview

ACCU-Torq® Motors

Totally Enclosed, Non-Ventilated (TENV) Vector Duty, C-Face, 2000:1 Constant Torque

Applications:

For use with inverters and in vector drive applications. Particularly suited for applications requiring up to a 2000:1 constant torque speed range. Typical applications: machine tools, material handling, packaging machines, test equipment, and other industrial machinery

HP	Base RPM	Max. RPM	Rated Voltage	Frame Size	Catalog Number	Discount Symbol	"C" Dim. (Inches)	F.L. Amps	Rated Torque lb-in	Inertia lb-in-sec ²	Weight lbs.	Frame Material
0.25	1800	3600	230/460	56C	UN14T2BC	DS-VFM	12.94	1.0/0.5	8.4	0.026	29	Steel
0.33	1800	3600	230/460	56C	UN13T2BC	DS-VFM	14.44	1.1/0.6	12.0	0.036	37	Steel
0.5	1800	3600	230/460	56C	UN12T2BC	DS-VFM	14.44	1.5/0.7	18.0	0.039	38	Steel
	1800	3600	575	56C	UN12T2GC	DS-VFM	14.44	0.6	18.0	0.039	37	Steel
1	1800	3600	230/460	56C	UN1T2BFC	DS-VFM	14.44	3.2/1.6	36.0	0.040	36	Steel
	1800	3600	575	56C	UN1T2GC	DS-VFM	14.44	1.300	36.0	0.040	36	Steel
	1800	3600	230/460	143TC	UN1T2BC	DS-VFM	14.5	3.2/1.6	36.0	0.040	37	Steel
	1200	2400	230/460	145TC	UN1T3BC	DS-VFM	14.5	3.6/1.8	55.2	0.045	42	Steel
1.5	1800	3600	230/460	145TC	UN32T2BC	DS-VFM	14.5	4.6/2.3	54.0	0.052	36	Steel
2	1800	3600	230/460	145TC	UN2T2BC	DS-VFM	14.5	5.6/2.8	72.0	0.065	53	Steel
	1800	3600	575	145TC	UN2T2GC	DS-VFM	15.5	2.2	72.0	0.065	53	Steel
	1200	2400	230/460	184TC	UN2T3BC	DS-VFM	16.58	6.2/3.1	108.0	0.134	64	Aluminum
3	1800	3600	230/460	182TC	UN3T2BC	DS-VFM	15.93	10.0/5.0	106.8	0.117	59	Aluminum
	1800	3600	575	182TC	UN3T2GC	DS-VFM	15.93	4.1	106.8	0.117	58	Aluminum
	1200	2400	230/460	213TC	UN3T3BC	DS-VFM	18.52	9.0/4.5	160.8	0.254	127	Aluminum
5	1800	3600	230/460	184TC	UN5T2BC	DS-VFM	16.68	14.0/7.0	177.6	0.176	78	Aluminum
	1800	3600	575	184TC	UN5T2GC	DS-VFM	16.68	5.6	177.6	0.176	77	Aluminum
	1200	2400	230/460	215TC	UN5T3BC	DS-VFM	20.02	16.0/8.0	267.6	0.344	129	Aluminum
7.5	1800	3600	230/460	213TC	UN7T2BC	DS-VFM	20.02	18.8/9.4	266.4	0.359	125	Aluminum
	1800	3600	575	213TC	UN7T2GC	DS-VFM	20.02	7.5	266.4	0.359	127	Aluminum
	1200	2400	230/460	254TC	UN7T3BC	DS-VFM	23.12	19.8/9.9	398.4	1.194	286	Aluminum
10	1800	3600	230/460	215TC	UN10T2BC	DS-VFM	23.02	25.4/12.7	355.2	0.494	172	Aluminum
	1800	3600	575	215TC	UN10T2GC	DS-VFM	23.02	10.0	355.2	0.494	125	Aluminum
	1200	2400	230/460	256TC	UN10T3BC	DS-VFM	24.87	25.3/12.7	540.0	1.506	227	Aluminum
15	1800	3600	230/460	254TC	UN15T2BC	DS-VFM	24.87	36.0/17.8	530.4	1.274	265	Aluminum
	1800	3600	575	254TC	UN15T2GC	DS-VFM	24.87	14.2	530.4	1.274	270	Aluminum
20	1800	3600	230/460	256TC	*UN20T2BC	DS-VFM	26.31	50.0/24.8	706.8	1.325	270	Aluminum
	1800	3600	575	256TC	*UN20T2GC	DS-VFM	26.31	19.8	706.8	1.325	270	Aluminum

* Constant Horsepower Up To 105hz

Conversion Options

Ask your Emerson Motors sales person for pre-assembled encoder, brake, & shaft grounding ring options on ACCU-Torq® motors - **NO EXTRA ASSEMBLY CHARGE**

ACCU-Torq® Motor Encoder Options

- All Encoders Listed Have 'Line-Driver' Outputs
- Encoders Available In 1024 & 2048 ppr; Please ask your EMR Sales Person
- Encoder Cables Not Supplied by Emerson

Base Model	Manufacturer	Size	Supply Volts	Connector	Application
HS20	Dynapar	2.0"	5-26v DC	MS 10-pin	Medium Duty
HS35	Dynapar	3.5"	5-26v DC	MS 10-pin	Heavy Duty
SL56	Dynapar	for 4.5" A-K	5-15v DC	Epic Solderless	For Brake Use**
Model 260	EPC	2.0"	5-28v DC	M-12*	Light Duty
25T	EPC	2.5"	5-28v DC	MS 10-pin	Medium Duty
Model 770	EPC	for 4.5" A-K	5-28v DC	MS 10-pin	For Brake Use**
*Mating Connectors Not Provided For M12 Connection					
**For Use of Brake Along with Encoder on Motor, Please Select These Encoders					

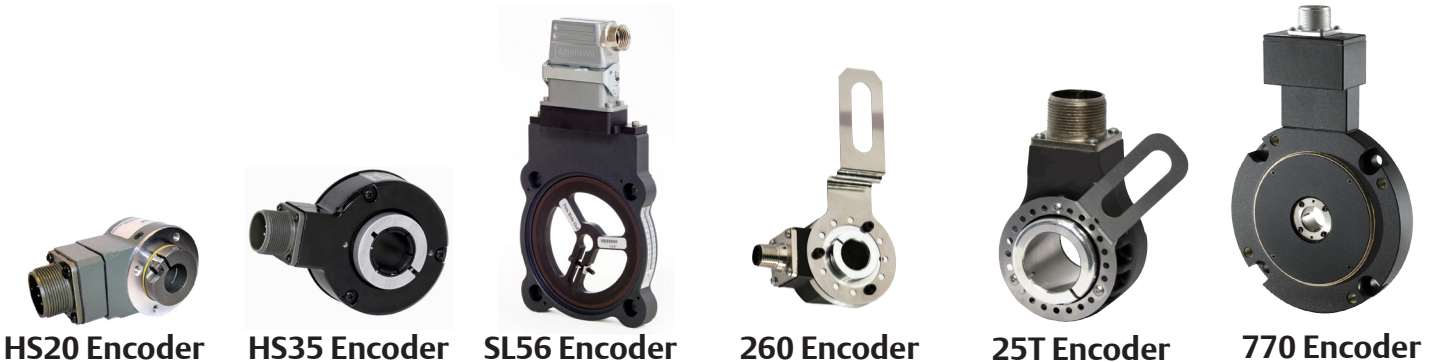

Conversion Options

Ask your Emerson Motors sales person for pre-assembled encoder, brake, & shaft grounding ring options on ACCU-Torq® motors - **NO EXTRA ASSEMBLY CHARGE**

ACCU-Torq® Motor Brake Options

Make	Coil Volts (v-ac)	Holding Torque (lb-ft)	Discount Symbol
Stearns	575	10 lb-ft	DS-VFM
Stearns	575	6 lb-ft	DS-VFM
Stearns	208-230/460	10 lb-ft	DS-VFM
Stearns	208-230/460	6 lb-ft	DS-VFM
Stearns	115/208-230	10 lb-ft	DS-VFM
Stearns	115/208-230	6 lb-ft	DS-VFM
Connections To Brakes: Flying Leads In Brake Enclosure			
Brakes Rated For 'Holding' Only - Not to be Applied for Stopping			
Universal Mount - For Vertical and Horizontal Mounted Motors			

ACCU-Torq® Motor Shaft-Grounding Ring Option

- Reduces Potential Bearing Failures Caused By Induced Shaft Currents
- AEGIS®† Brand

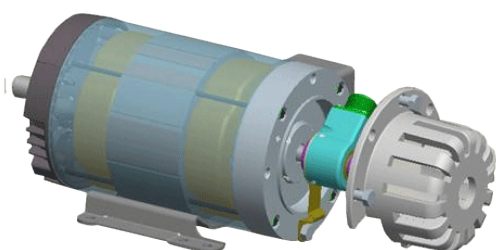
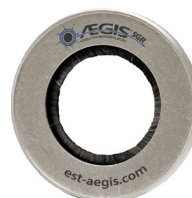

ACCU-Torq® Motor & Encoder Configuration

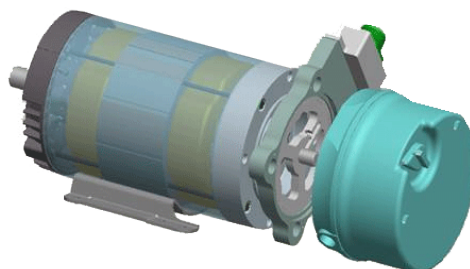

ACCU-Torq® Motor, Encoder & Brake Configuration

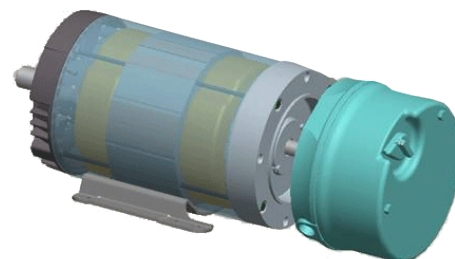

ACCU-Torq® Motor & Brake Configuration

Emerson trademarks followed by the ® symbol are registered with the U.S. Patent and Trademark Office.
 †All non-Emerson Electric Co. marks shown within this document are properties of their respective owners.

Emerson (NYSE:EMR), based in St. Louis, Missouri (USA), is a global leader in bringing technology and engineering together to provide innovative solutions to customers through its network power, process management, industrial automation, climate technologies, and appliance and tools businesses. Sales in fiscal 2008 were \$24.8 billion and Emerson is ranked 94th on the Fortune 500 list of America's largest companies. For more information, visit www.Emerson.com.

Emerson Motor Company

8100 West Florissant Ave.
 St. Louis, MO 63136
 Phone: 888-637-7333
 Fax: 314-553-2087
www.emersonmotors.com
www.usmotors.com

